

LOT 407

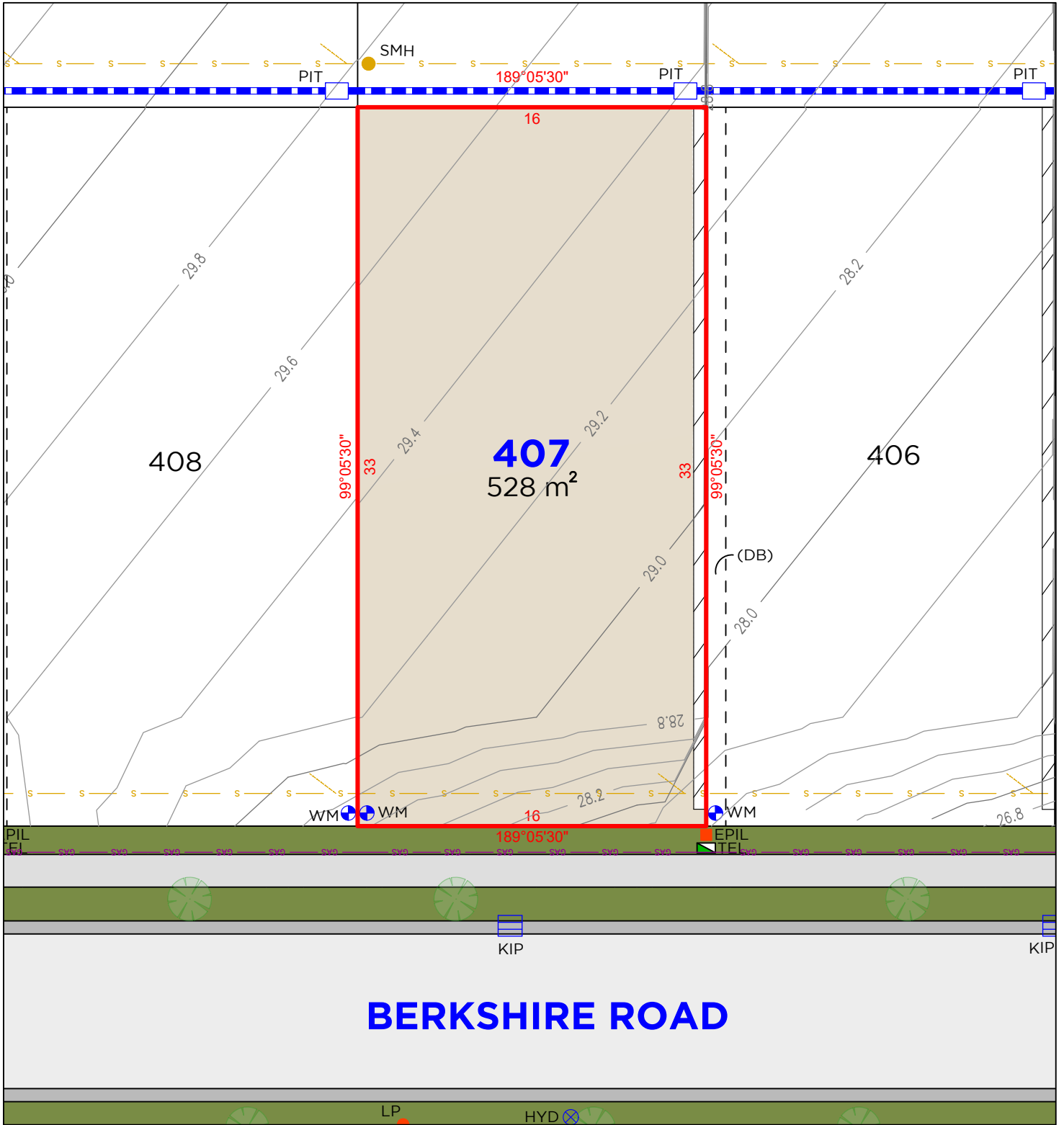

LEGEND

	BOUNDARY LINE
	ADJACENT BOUNDARY
	EASEMENT
	SEWER
	GAS LINE
	STORMWATER
	RETAINING WALL
	WM WATER METER
	LP LIGHT POLE

	TEL TELSTRA / NBN PIT
	EPIL ELECTRICAL PILLAR
	PIT DRAINAGE PIT
	KIP KERB INLET PIT
	SV STOP VALVE
	HYD HYDRANT

EASEMENTS

(DB) EASEMENT FOR SUPPORT OF RETAINING WALL 0.9 WIDE

DISCLAIMER

1. THIS PLAN HAS BEEN COMPILED FROM DESIGN PLANS AT THE SCALE/S STATED. IT IS RECOMMENDED THAT A SURVEY IS UNDERTAKEN PRIOR TO THE PREPARATION OF CONSTRUCTION DRAWINGS. THE PLAN IS SUITABLE FOR DESIGN ONLY & MAY NOT BE SUITABLE FOR ANY OTHER PURPOSE OR FOR USE AT ANY OTHER SCALES/S.
2. THE BOUNDARIES & SERVICES SHOWN ARE APPROXIMATE ONLY. FURTHER SURVEY WILL BE REQUIRED IF CONSTRUCTION IS TO TAKE PLACE ON OR ADJACENT TO THE BOUNDARIES.



LOT 408

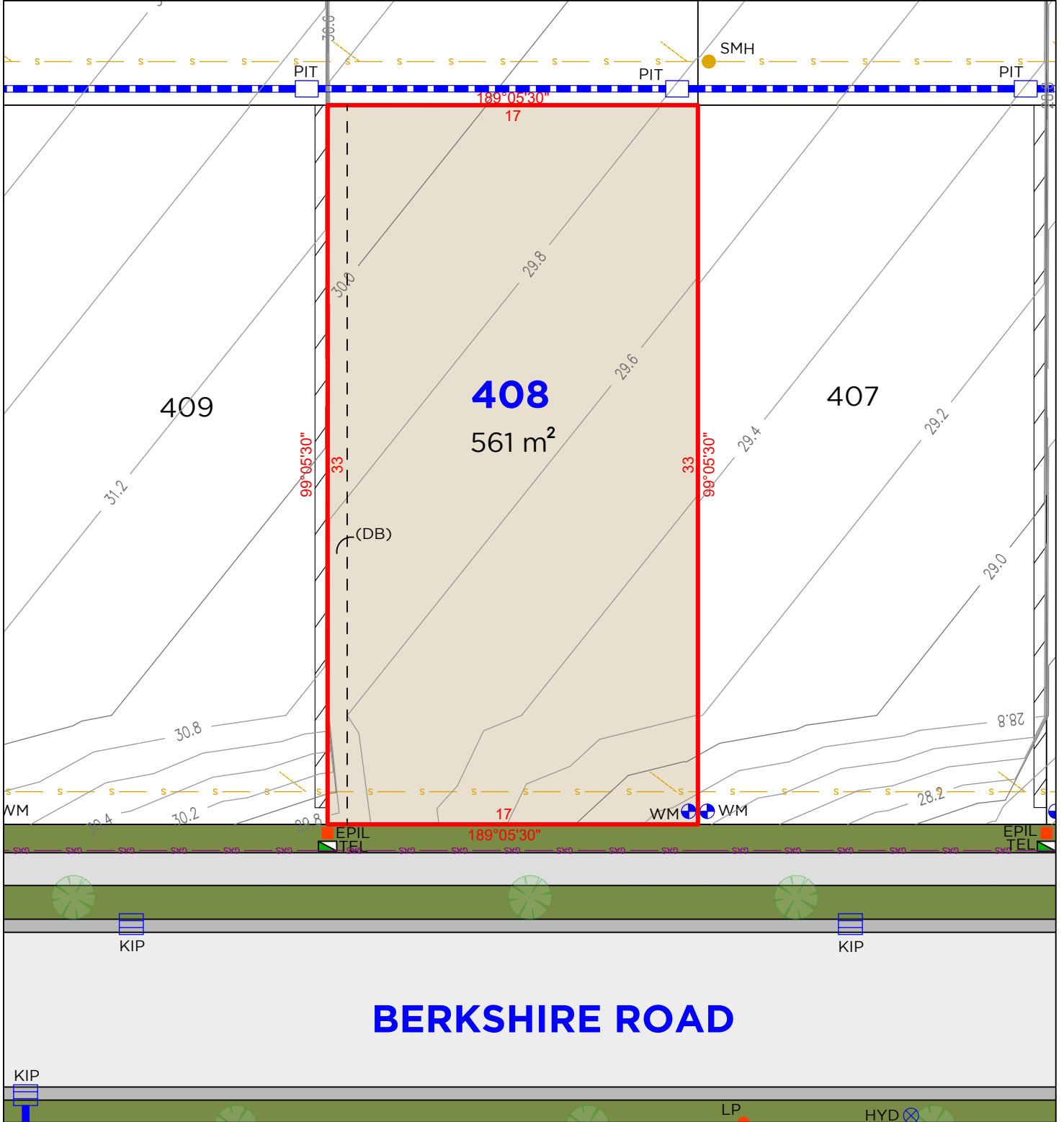

LEGEND

—	BOUNDARY LINE
---	ADJACENT BOUNDARY
---	EASEMENT
S	SEWER
GAS	GAS LINE
---	STORMWATER
/ / /	RETAINING WALL
+	WM
●	LP

TEL	TELSTRA / NBN PIT
EPIL	ELECTRICAL PILLAR
PIT	DRAINAGE PIT
KIP	KERB INLET PIT
SV	STOP VALVE
HYD	HYDRANT

EASEMENTS

(DB) EASEMENT FOR SUPPORT OF RETAINING WALL 0.9 WIDE

DISCLAIMER

- THIS PLAN HAS BEEN COMPILED FROM DESIGN PLANS AT THE SCALE/S STATED. IT IS RECOMMENDED THAT A SURVEY IS UNDERTAKEN PRIOR TO THE PREPARATION OF CONSTRUCTION DRAWINGS. THE PLAN IS SUITABLE FOR DESIGN ONLY & MAY NOT BE SUITABLE FOR ANY OTHER PURPOSE OR FOR USE AT ANY OTHER SCALES/S.
- THE BOUNDARIES & SERVICES SHOWN ARE APPROXIMATE ONLY. FURTHER SURVEY WILL BE REQUIRED IF CONSTRUCTION IS TO TAKE PLACE ON OR ADJACENT TO THE BOUNDARIES.



LOT 409

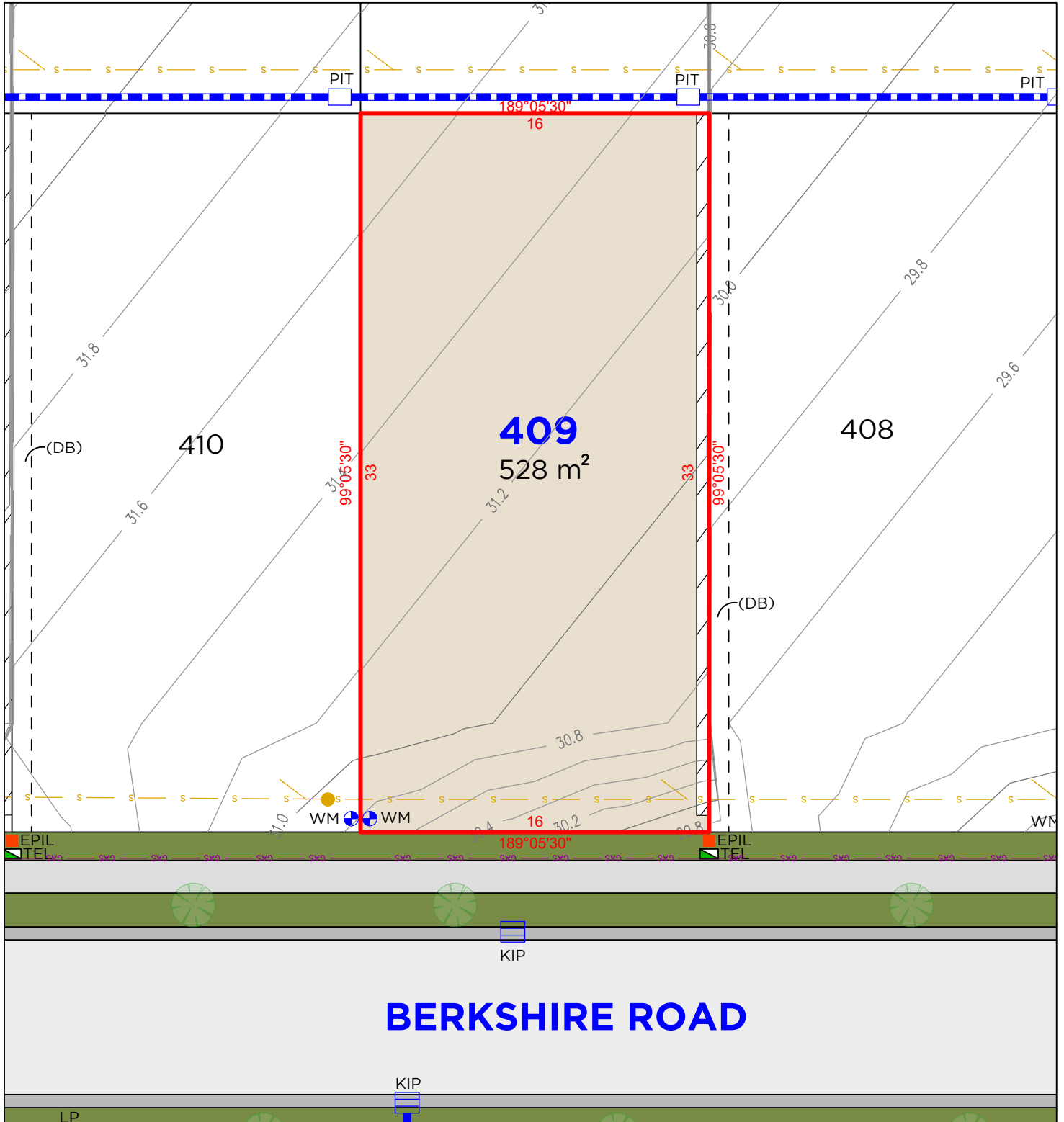

LEGEND

—	BOUNDARY LINE
---	ADJACENT BOUNDARY
---	EASEMENT
S	SEWER
G	GAS LINE
---	STORMWATER
/ / /	RETAINING WALL
+	WM
●	LP

TEL	TELSTRA / NBN PIT
EPIL	ELECTRICAL PILLAR
PIT	DRAINAGE PIT
KIP	KERB INLET PIT
SV	STOP VALVE
HYD	HYDRANT

EASEMENTS

(DB) EASEMENT FOR SUPPORT OF RETAINING WALL 0.9 WIDE

DISCLAIMER

- THIS PLAN HAS BEEN COMPILED FROM DESIGN PLANS AT THE SCALE/S STATED. IT IS RECOMMENDED THAT A SURVEY IS UNDERTAKEN PRIOR TO THE PREPARATION OF CONSTRUCTION DRAWINGS. THE PLAN IS SUITABLE FOR DESIGN ONLY & MAY NOT BE SUITABLE FOR ANY OTHER PURPOSE OR FOR USE AT ANY OTHER SCALES/S.
- THE BOUNDARIES & SERVICES SHOWN ARE APPROXIMATE ONLY. FURTHER SURVEY WILL BE REQUIRED IF CONSTRUCTION IS TO TAKE PLACE ON OR ADJACENT TO THE BOUNDARIES.



LOT 416

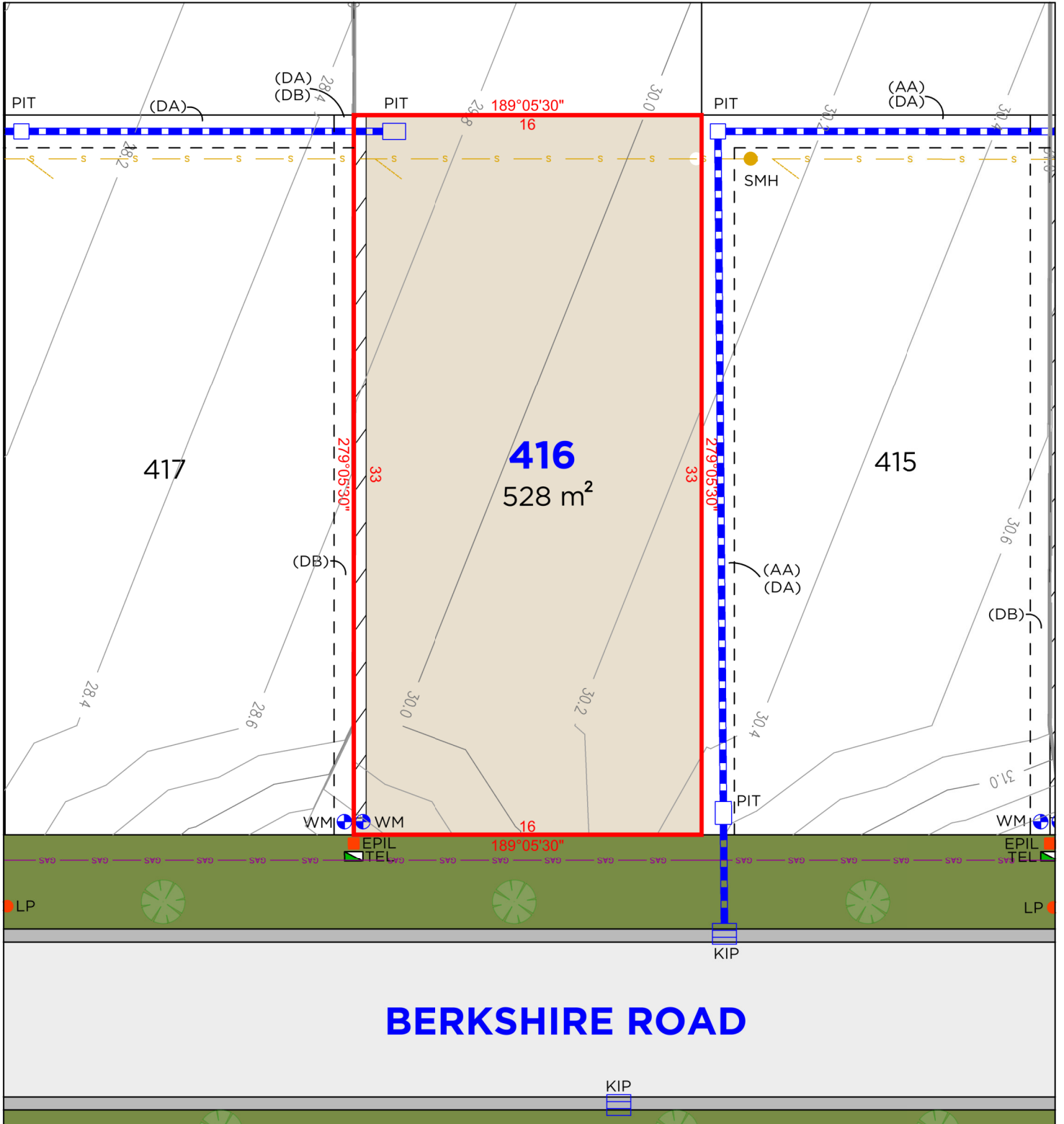

BERKSHIRE ROAD

LEGEND

—	BOUNDARY LINE
---	ADJACENT BOUNDARY
---	EASEMENT
S	SEWER
GAS	GAS LINE
---	STORMWATER
---	RETAINING WALL
+	WM
●	LP

TEL	TELSTRA / NBN PIT
EPIL	ELECTRICAL PILLAR
PIT	DRAINAGE PIT
KIP	KERB INLET PIT
SV	STOP VALVE
HYD	HYDRANT

EASEMENTS

(AA) EASEMENT TO DRAIN WATER 1.5 WIDE
(AB) EASEMENT FOR SUPPORT OF RETAINING WALL 0.9 WIDE
(DA) EASEMENT TO DRAIN WATER 1.5 WIDE
(DB) EASEMENT FOR SUPPORT OF RETAINING WALL 0.9 WIDE

DISCLAIMER

- THIS PLAN HAS BEEN COMPILED FROM DESIGN PLANS AT THE SCALE/S STATED. IT IS RECOMMENDED THAT A SURVEY IS UNDERTAKEN PRIOR TO THE PREPARATION OF CONSTRUCTION DRAWINGS. THE PLAN IS SUITABLE FOR DESIGN ONLY & MAY NOT BE SUITABLE FOR ANY OTHER PURPOSE OR FOR USE AT ANY OTHER SCALES/S.
- THE BOUNDARIES & SERVICES SHOWN ARE APPROXIMATE ONLY. FURTHER SURVEY WILL BE REQUIRED IF CONSTRUCTION IS TO TAKE PLACE ON OR ADJACENT TO THE BOUNDARIES.



LOT 417

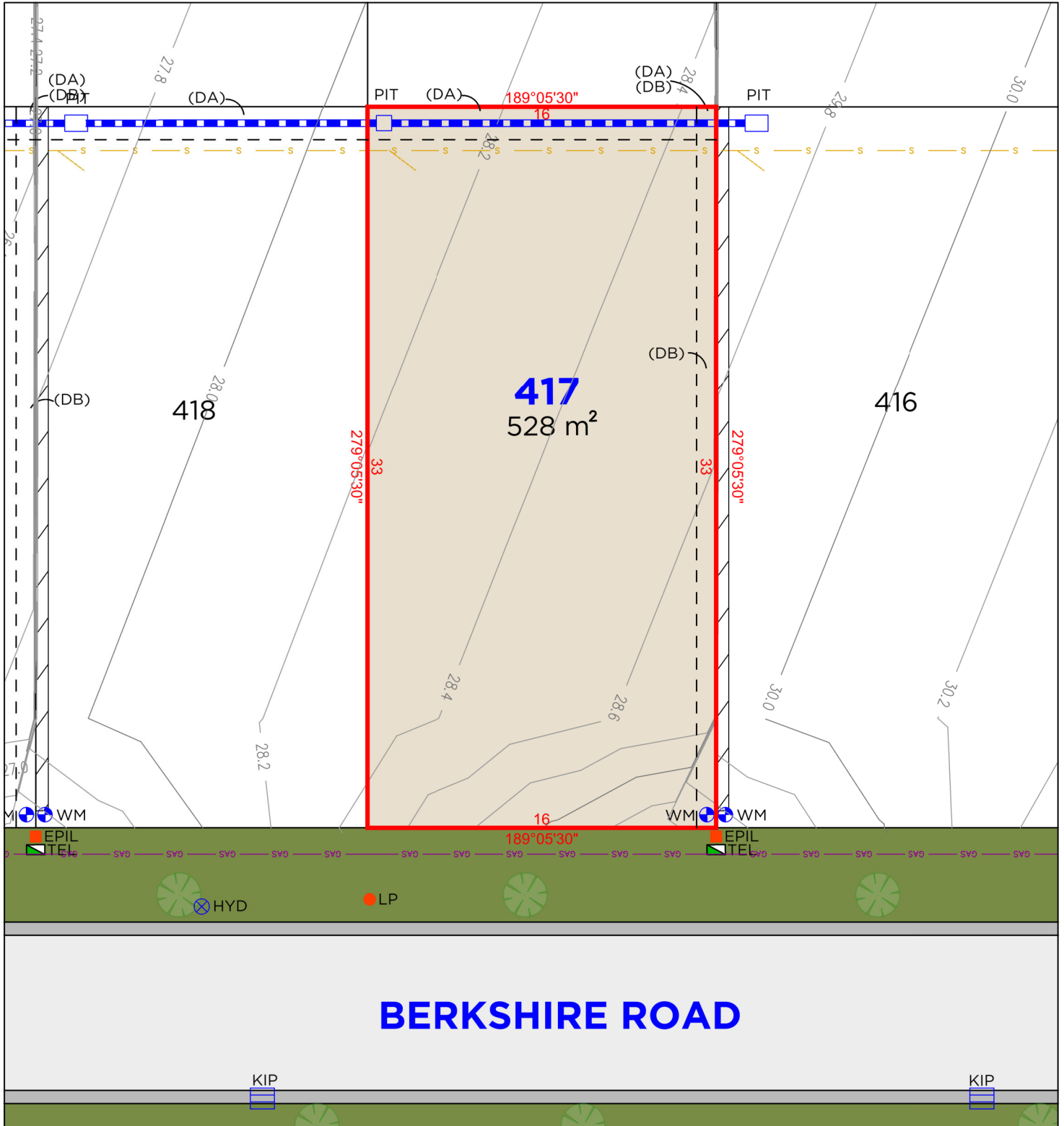

LEGEND

—	BOUNDARY LINE
---	ADJACENT BOUNDARY
---	EASEMENT
S	SEWER
GAS	GAS LINE
---	STORMWATER
/ /	RETAINING WALL
WM	WATER METER
LP	LIGHT POLE

TEL	TELSTRA / NBN PIT
EPIL	ELECTRICAL PILLAR
PIT	DRAINAGE PIT
KIP	KERB INLET PIT
SV	STOP VALVE
HYD	HYDRANT

EASEMENTS

(DA) EASEMENT TO DRAIN WATER 1.5 WIDE
(DB) EASEMENT FOR SUPPORT OF RETAINING WALL 0.9 WIDE

DISCLAIMER

- THIS PLAN HAS BEEN COMPILED FROM DESIGN PLANS AT THE SCALE/S STATED. IT IS RECOMMENDED THAT A SURVEY IS UNDERTAKEN PRIOR TO THE PREPARATION OF CONSTRUCTION DRAWINGS. THE PLAN IS SUITABLE FOR DESIGN ONLY & MAY NOT BE SUITABLE FOR ANY OTHER PURPOSE OR FOR USE AT ANY OTHER SCALES/S.
- THE BOUNDARIES & SERVICES SHOWN ARE APPROXIMATE ONLY. FURTHER SURVEY WILL BE REQUIRED IF CONSTRUCTION IS TO TAKE PLACE ON OR ADJACENT TO THE BOUNDARIES.



LOT 418

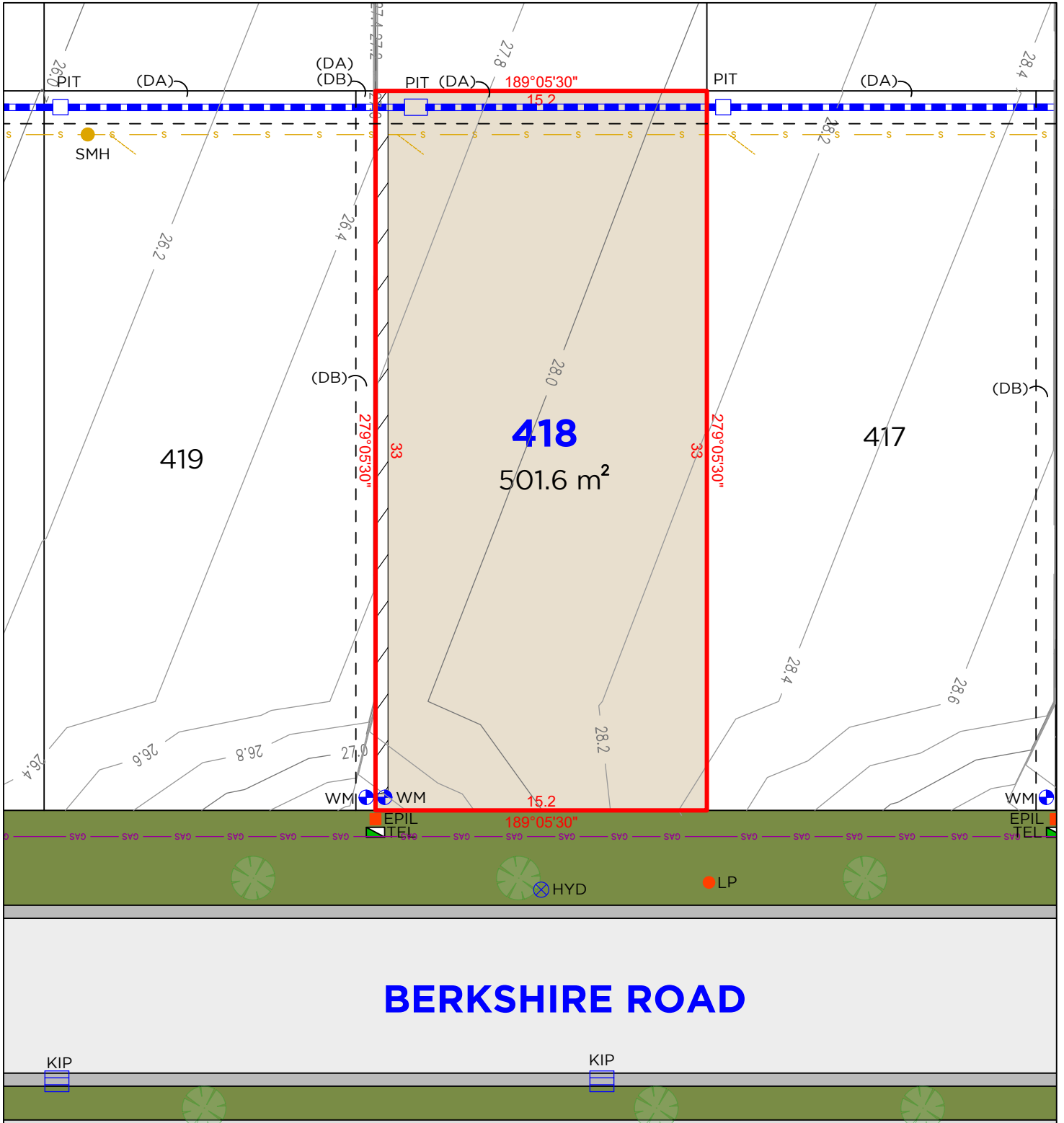

LEGEND

———	BOUNDARY LINE
———	ADJACENT BOUNDARY
- - - - -	EASEMENT
———	SEWER
———	GAS LINE
———	STORMWATER
/ / / / /	RETAINING WALL
●	WM
●	LP

■	TEL	TELSTRA / NBN PIT
■	EPIL	ELECTRICAL PILLAR
□	PIT	DRAINAGE PIT
□	KIP	KERB INLET PIT
○	SV	STOP VALVE
⊗	HYD	HYDRANT

EASEMENTS

(DA) EASEMENT TO DRAIN WATER 1.5 WIDE
(DB) EASEMENT FOR SUPPORT OF RETAINING WALL 0.9 WIDE

DISCLAIMER

1. THIS PLAN HAS BEEN COMPILED FROM DESIGN PLANS AT THE SCALE/S STATED. IT IS RECOMMENDED THAT A SURVEY IS UNDERTAKEN PRIOR TO THE PREPARATION OF CONSTRUCTION DRAWINGS. THE PLAN IS SUITABLE FOR DESIGN ONLY & MAY NOT BE SUITABLE FOR ANY OTHER PURPOSE OR FOR USE AT ANY OTHER SCALES/S.
2. THE BOUNDARIES & SERVICES SHOWN ARE APPROXIMATE ONLY. FURTHER SURVEY WILL BE REQUIRED IF CONSTRUCTION IS TO TAKE PLACE ON OR ADJACENT TO THE BOUNDARIES.



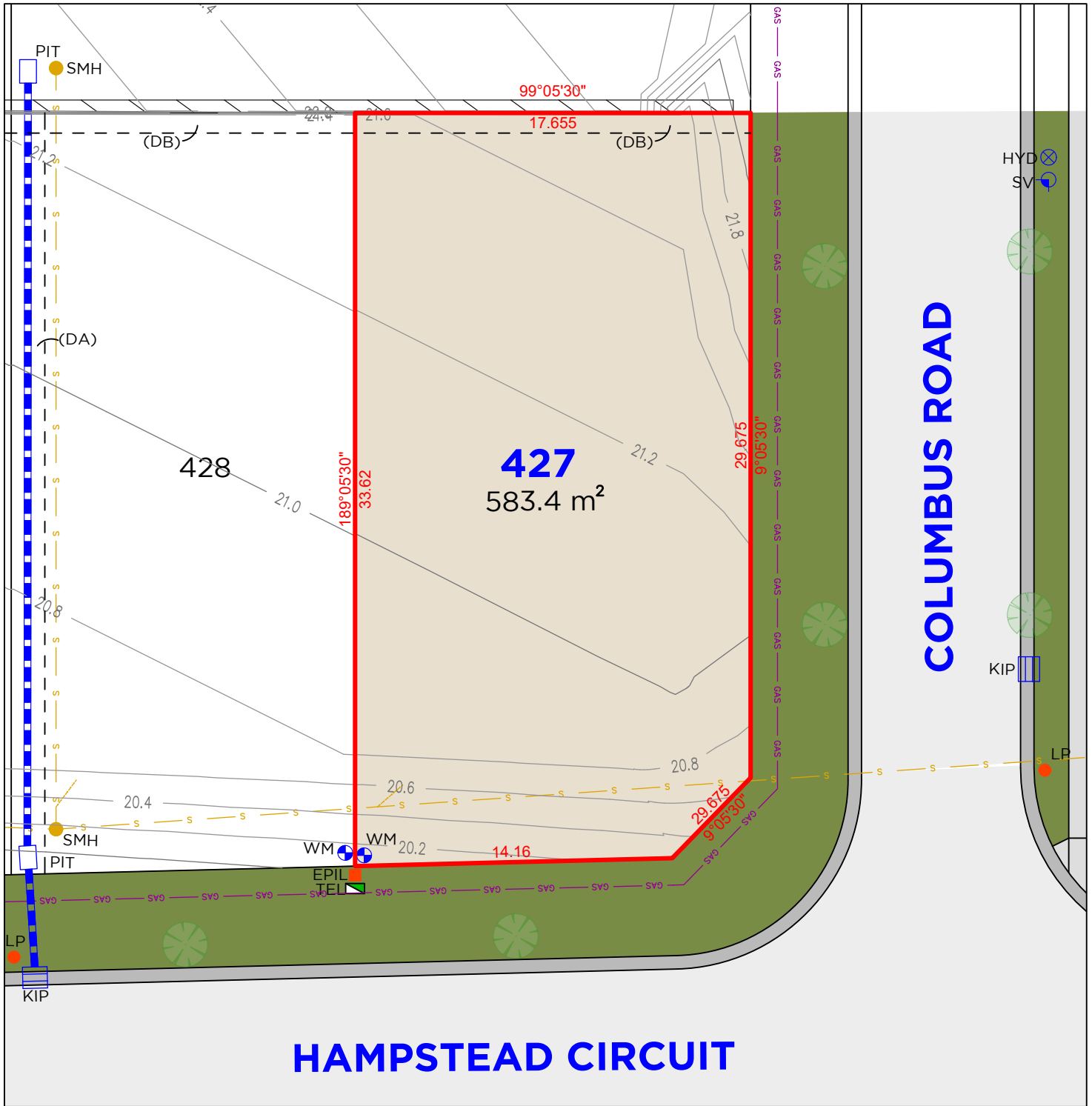

LEGEND

—	BOUNDARY LINE
---	ADJACENT BOUNDARY
---	EASEMENT
---	SEWER
---	GAS LINE
---	STORMWATER
---	RETAINING WALL
●	WM WATER METER
●	LP LIGHT POLE

■	TEL TELSTRA / NBN PIT
■	EPIL ELECTRICAL PILLAR
□	PIT DRAINAGE PIT
□	KIP KERB INLET PIT
○	SV STOP VALVE
⊗	HYD HYDRANT

EASEMENTS

(DA) EASEMENT TO DRAIN WATER 1.5 WIDE
(DB) EASEMENT FOR SUPPORT OF RETAINING WALL 0.9 WIDE

DISCLAIMER

- THIS PLAN HAS BEEN COMPILED FROM DESIGN PLANS AT THE SCALE/S STATED. IT IS RECOMMENDED THAT A SURVEY IS UNDERTAKEN PRIOR TO THE PREPARATION OF CONSTRUCTION DRAWINGS. THE PLAN IS SUITABLE FOR DESIGN ONLY & MAY NOT BE SUITABLE FOR ANY OTHER PURPOSE OR FOR USE AT ANY OTHER SCALES/S.
- THE BOUNDARIES & SERVICES SHOWN ARE APPROXIMATE ONLY. FURTHER SURVEY WILL BE REQUIRED IF CONSTRUCTION IS TO TAKE PLACE ON OR ADJACENT TO THE BOUNDARIES.



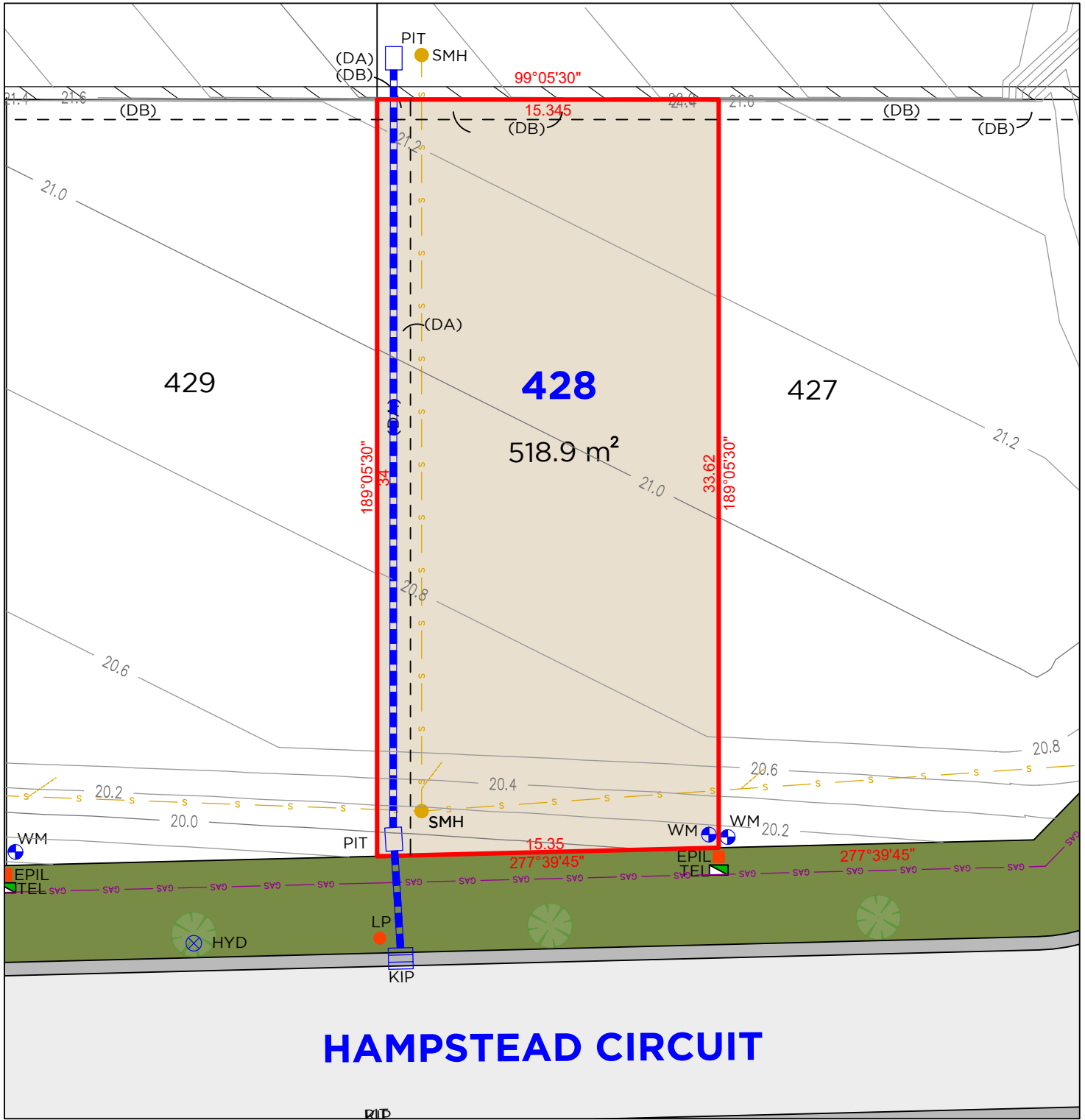

LEGEND

	BOUNDARY LINE
	ADJACENT BOUNDARY
	EASEMENT
	SEWER
	GAS LINE
	STORMWATER
	RETAINING WALL
	WATER METER
	LIGHT POLE

	TELSTRA / NBN PIT
	ELECTRICAL PILLAR
	DRAINAGE PIT
	KERB INLET PIT
	STOP VALVE
	HYDRANT

EASEMENTS

(DA) EASEMENT TO DRAIN WATER 1.5 WIDE
(DB) EASEMENT FOR SUPPORT OF RETAINING WALL 0.9 WIDE

DISCLAIMER

- THIS PLAN HAS BEEN COMPILED FROM DESIGN PLANS AT THE SCALE/S STATED. IT IS RECOMMENDED THAT A SURVEY IS UNDERTAKEN PRIOR TO THE PREPARATION OF CONSTRUCTION DRAWINGS. THE PLAN IS SUITABLE FOR DESIGN ONLY & MAY NOT BE SUITABLE FOR ANY OTHER PURPOSE OR FOR USE AT ANY OTHER SCALES/S.
- THE BOUNDARIES & SERVICES SHOWN ARE APPROXIMATE ONLY. FURTHER SURVEY WILL BE REQUIRED IF CONSTRUCTION IS TO TAKE PLACE ON OR ADJACENT TO THE BOUNDARIES.





	BOUNDARY LINE
	ADJACENT BOUNDARY
	EASEMENT
	SEWER
	GAS LINE
	STORMWATER
	RETAINING WALL
	WM WATER METER
	LP LIGHT POLE

	TEL	TELSTRA / NBN PIT
	EPIL	ELECTRICAL PILLAR
	PIT	DRAINAGE PIT
	KIP	KERB INLET PIT
	SV	STOP VALVE
	HYD	HYDRANT

(DA) EASEMENT TO DRAIN WATER 1.5 WIDE
(DB) EASEMENT FOR SUPPORT OF RETAINING WALL 0.9 WIDE

1. THIS PLAN HAS BEEN COMPILED FROM DESIGN PLANS AT THE SCALE/S STATED. IT IS RECOMMENDED THAT A SURVEY IS UNDERTAKEN PRIOR TO THE PREPARATION OF CONSTRUCTION DRAWINGS. THE PLAN IS SUITABLE FOR DESIGN ONLY & MAY NOT BE SUITABLE FOR ANY OTHER PURPOSE OR FOR USE AT ANY OTHER SCALES/S.
2. THE BOUNDARIES & SERVICES SHOWN ARE APPROXIMATE ONLY. FURTHER SURVEY WILL BE REQUIRED IF CONSTRUCTION IS TO TAKE PLACE ON OR ADJACENT TO THE BOUNDARIES.



LOT 430

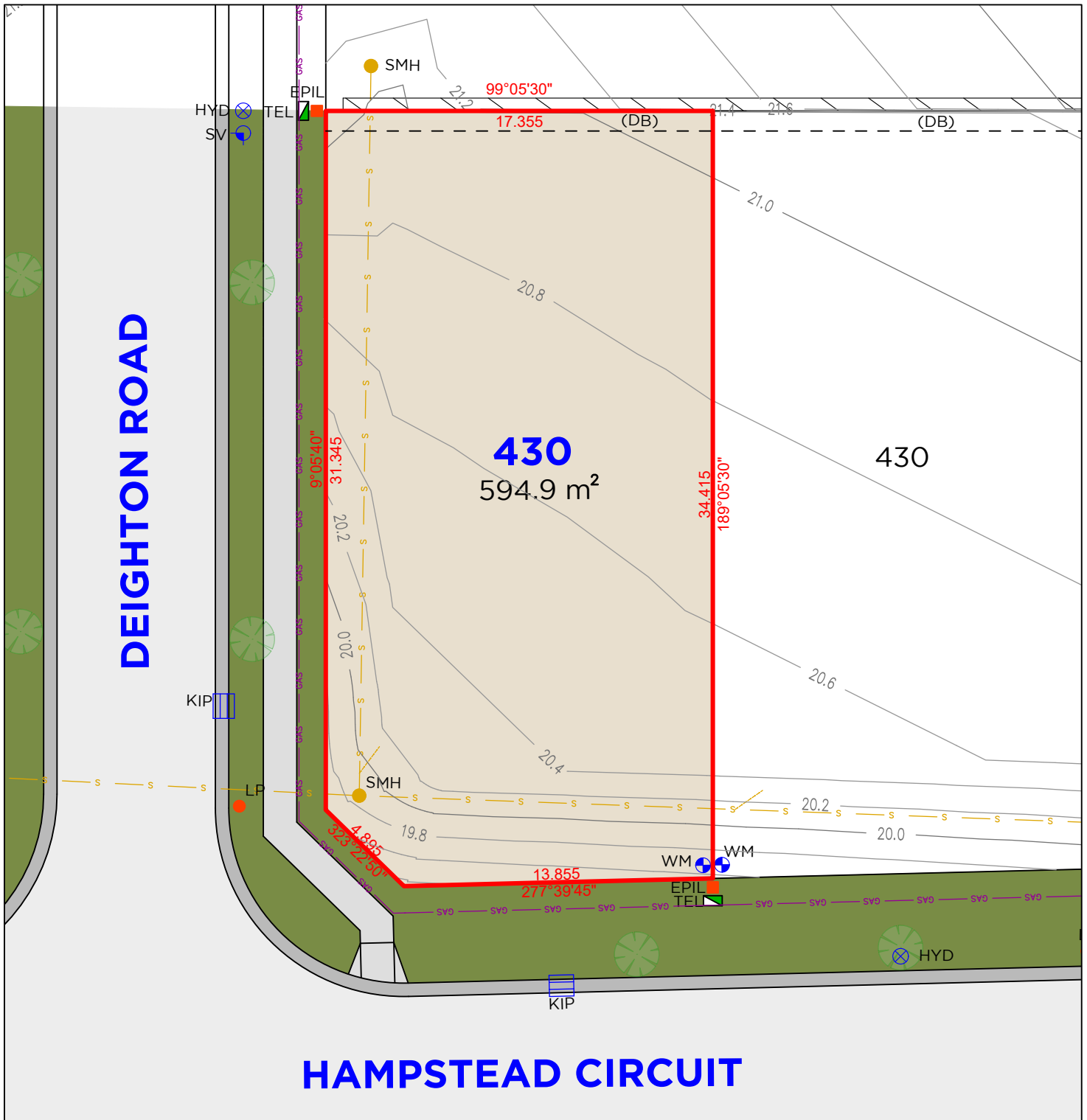

LEGEND

——	BOUNDARY LINE
---	ADJACENT BOUNDARY
---	EASEMENT
S	SEWER
GAS	GAS LINE
S	STORMWATER
/ / /	RETAINING WALL
⊕	WM WATER METER
●	LP LIGHT POLE

■	TEL TELSTRA / NBN PIT
■	EPIL ELECTRICAL PILLAR
□	PIT DRAINAGE PIT
□	KIP KERB INLET PIT
⊙	SV STOP VALVE
⊗	HYD HYDRANT

EASEMENTS

(DB) EASEMENT FOR SUPPORT OF RETAINING WALL 0.9 WIDE

DISCLAIMER

1. THIS PLAN HAS BEEN COMPILED FROM DESIGN PLANS AT THE SCALE/S STATED. IT IS RECOMMENDED THAT A SURVEY IS UNDERTAKEN PRIOR TO THE PREPARATION OF CONSTRUCTION DRAWINGS. THE PLAN IS SUITABLE FOR DESIGN ONLY & MAY NOT BE SUITABLE FOR ANY OTHER PURPOSE OR FOR USE AT ANY OTHER SCALES/S.
2. THE BOUNDARIES & SERVICES SHOWN ARE APPROXIMATE ONLY. FURTHER SURVEY WILL BE REQUIRED IF CONSTRUCTION IS TO TAKE PLACE ON OR ADJACENT TO THE BOUNDARIES.

