

# LOT 701

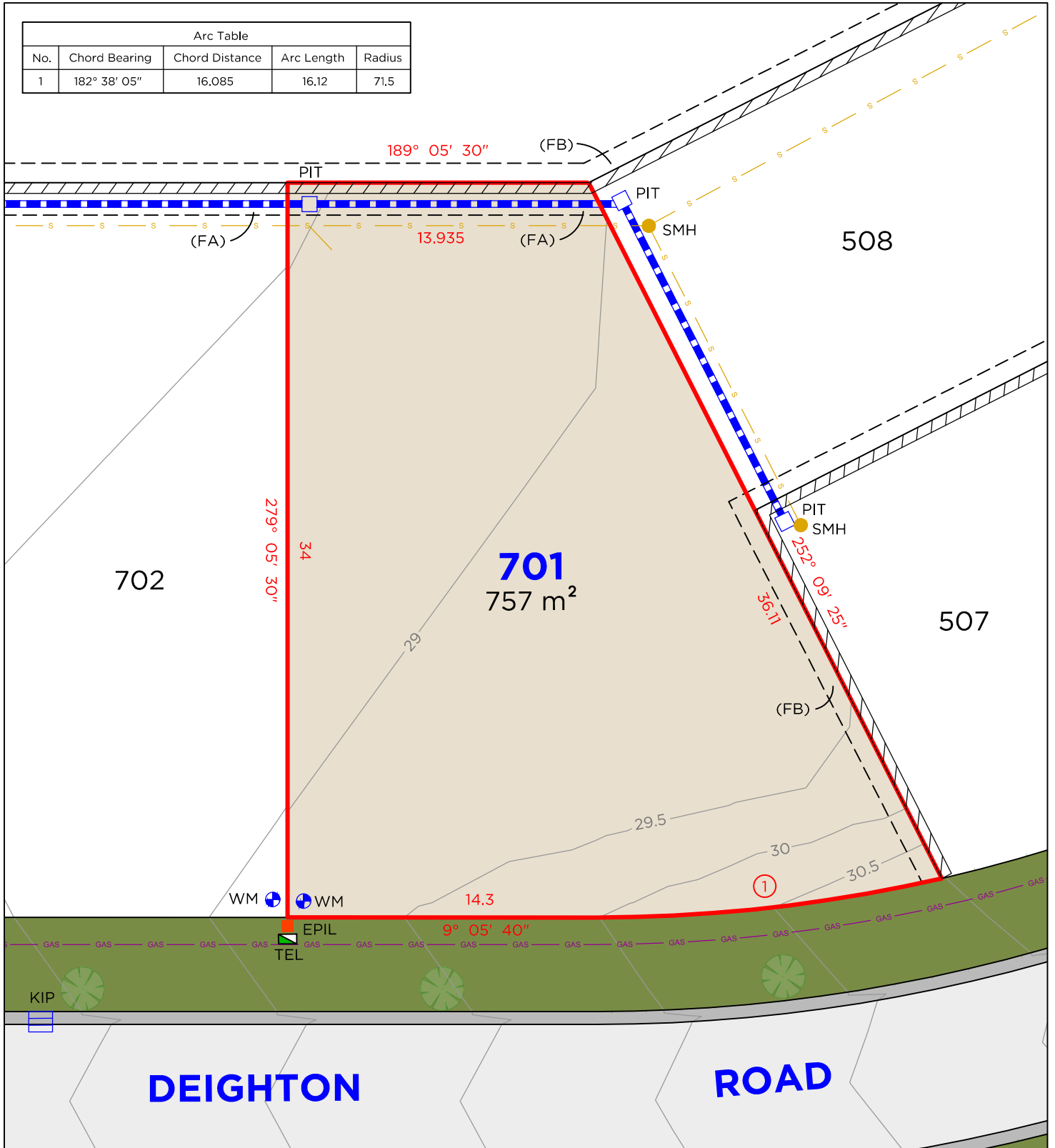

Arc Table				
No.	Chord Bearing	Chord Distance	Arc Length	Radius
1	182° 38' 05"	16.085	16.12	71.5



## LEGEND

<span style="color: red;">—</span>	BOUNDARY LINE
<span style="color: black;">---</span>	ADJACENT BOUNDARY
<span style="color: blue;">---</span>	EASEMENT
<span style="color: yellow;">—S—</span>	SEWER
<span style="color: purple;">—GAS—</span>	GAS LINE
<span style="color: blue;">—</span>	STORMWATER
<span style="color: black;">▨</span>	RETAINING WALL
<span style="color: yellow;">●</span>	SMH

<span style="color: green;">■</span>	TEL	TELSTRA / NBN PIT
<span style="color: orange;">■</span>	EPIL	ELECTRICAL PILLAR
<span style="color: blue;">■</span>	LP	LIGHT POLE
<span style="color: blue;">□</span>	PIT	DRAINAGE PIT
<span style="color: blue;">▢</span>	KIP	KERB INLET PIT
<span style="color: blue;">⊙</span>	SV	STOP VALVE
<span style="color: blue;">⊗</span>	HYD	HYDRANT
<span style="color: blue;">⊕</span>	WM	WATER METER

## EASEMENTS

- (FA) EASEMENT TO DRAIN WATER 1.5 WIDE  
(FB) EASEMENT FOR SUPPORT OF RETAINING WALL 0.9 WIDE

## DISCLAIMER

- THIS PLAN HAS BEEN COMPILED FROM DESIGN PLANS AT THE SCALE/S STATED. IT IS RECOMMENDED THAT A SURVEY IS UNDERTAKEN PRIOR TO THE PREPARATION OF CONSTRUCTION DRAWINGS. THE PLAN IS SUITABLE FOR DESIGN ONLY & MAY NOT BE SUITABLE FOR ANY OTHER PURPOSE OR FOR USE AT ANY OTHER SCALES/S.
- THE BOUNDARIES & SERVICES SHOWN ARE APPROXIMATE ONLY. FURTHER SURVEY WILL BE REQUIRED IF CONSTRUCTION IS TO TAKE PLACE ON OR ADJACENT TO THE BOUNDARIES.

**DELFS  
LASCELLES**  
CONSULTING SURVEYORS



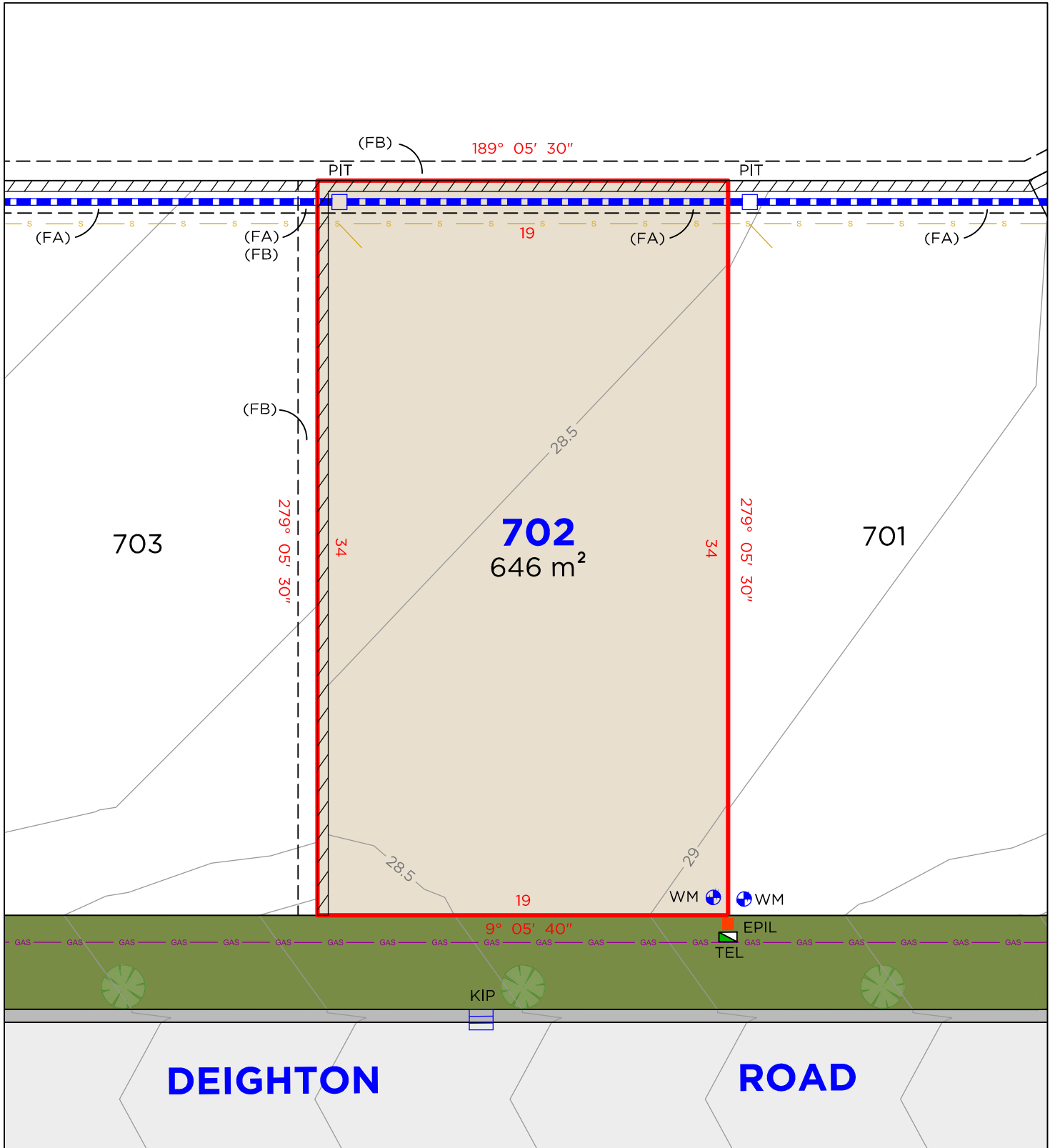

## LEGEND

<span style="color: red;">—</span>	BOUNDARY LINE
<span style="color: black;">---</span>	ADJACENT BOUNDARY
<span style="color: black;">---</span>	EASEMENT
<span style="color: yellow;">S</span>	SEWER
<span style="color: purple;">GAS</span>	GAS LINE
<span style="color: blue;">---</span>	STORMWATER
<span style="color: black;">/ / /</span>	RETAINING WALL
<span style="color: yellow;">●</span>	SMH

<span style="color: green;">●</span>	TEL	TELSTRA / NBN PIT
<span style="color: orange;">■</span>	EPIL	ELECTRICAL PILLAR
<span style="color: blue;">■</span>	LP	LIGHT POLE
<span style="color: blue;">■</span>	PIT	DRAINAGE PIT
<span style="color: blue;">▭</span>	KIP	KERB INLET PIT
<span style="color: blue;">○</span>	SV	STOP VALVE
<span style="color: blue;">○</span>	HYD	HYDRANT
<span style="color: blue;">○</span>	WM	WATER METER

## EASEMENTS

- (FA) EASEMENT TO DRAIN WATER 1.5 WIDE  
 (FB) EASEMENT FOR SUPPORT OF RETAINING WALL 0.9 WIDE

## DISCLAIMER

- THIS PLAN HAS BEEN COMPILED FROM DESIGN PLANS AT THE SCALE/S STATED. IT IS RECOMMENDED THAT A SURVEY IS UNDERTAKEN PRIOR TO THE PREPARATION OF CONSTRUCTION DRAWINGS. THE PLAN IS SUITABLE FOR DESIGN ONLY & MAY NOT BE SUITABLE FOR ANY OTHER PURPOSE OR FOR USE AT ANY OTHER SCALES/S.
- THE BOUNDARIES & SERVICES SHOWN ARE APPROXIMATE ONLY. FURTHER SURVEY WILL BE REQUIRED IF CONSTRUCTION IS TO TAKE PLACE ON OR ADJACENT TO THE BOUNDARIES.

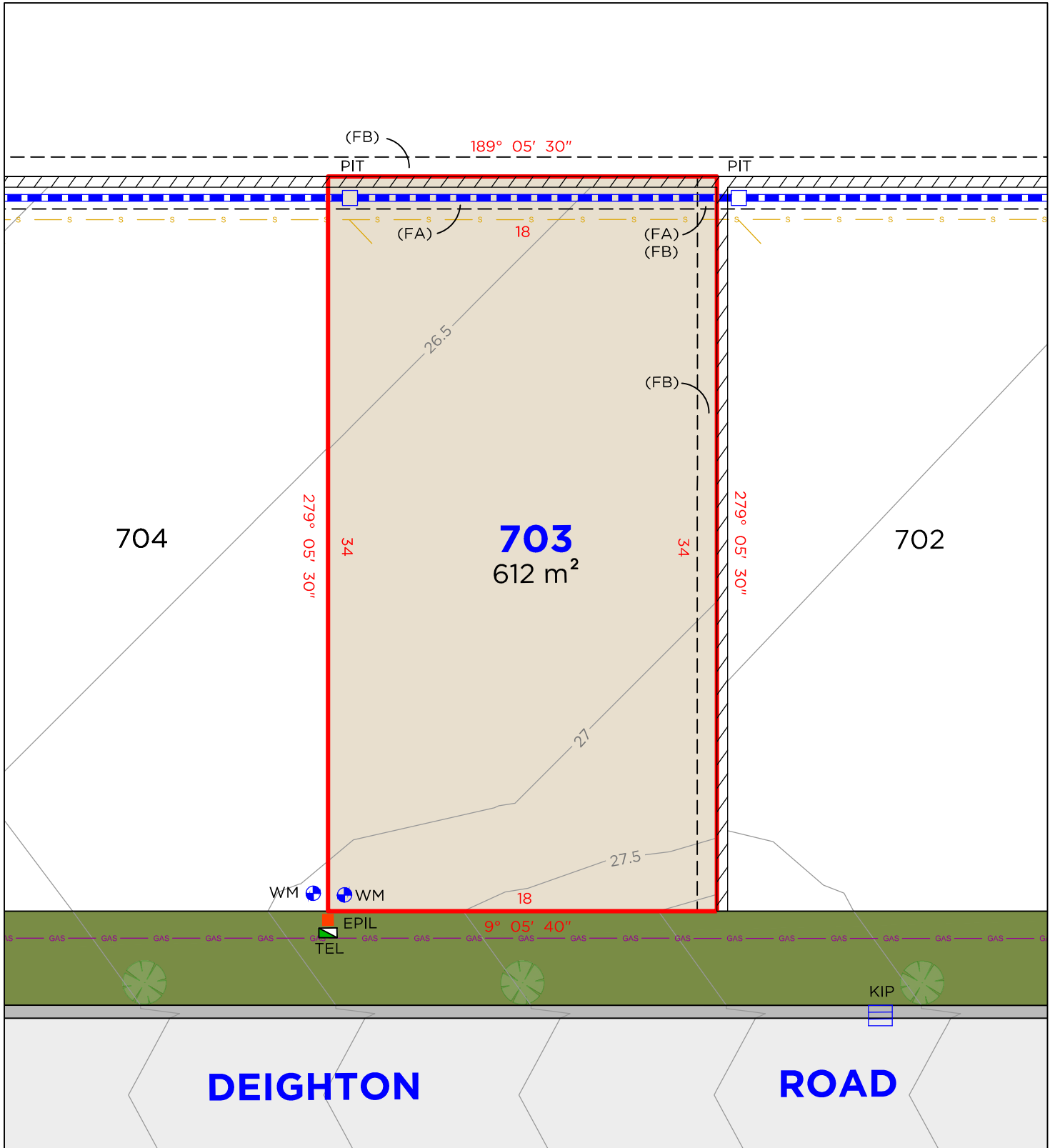

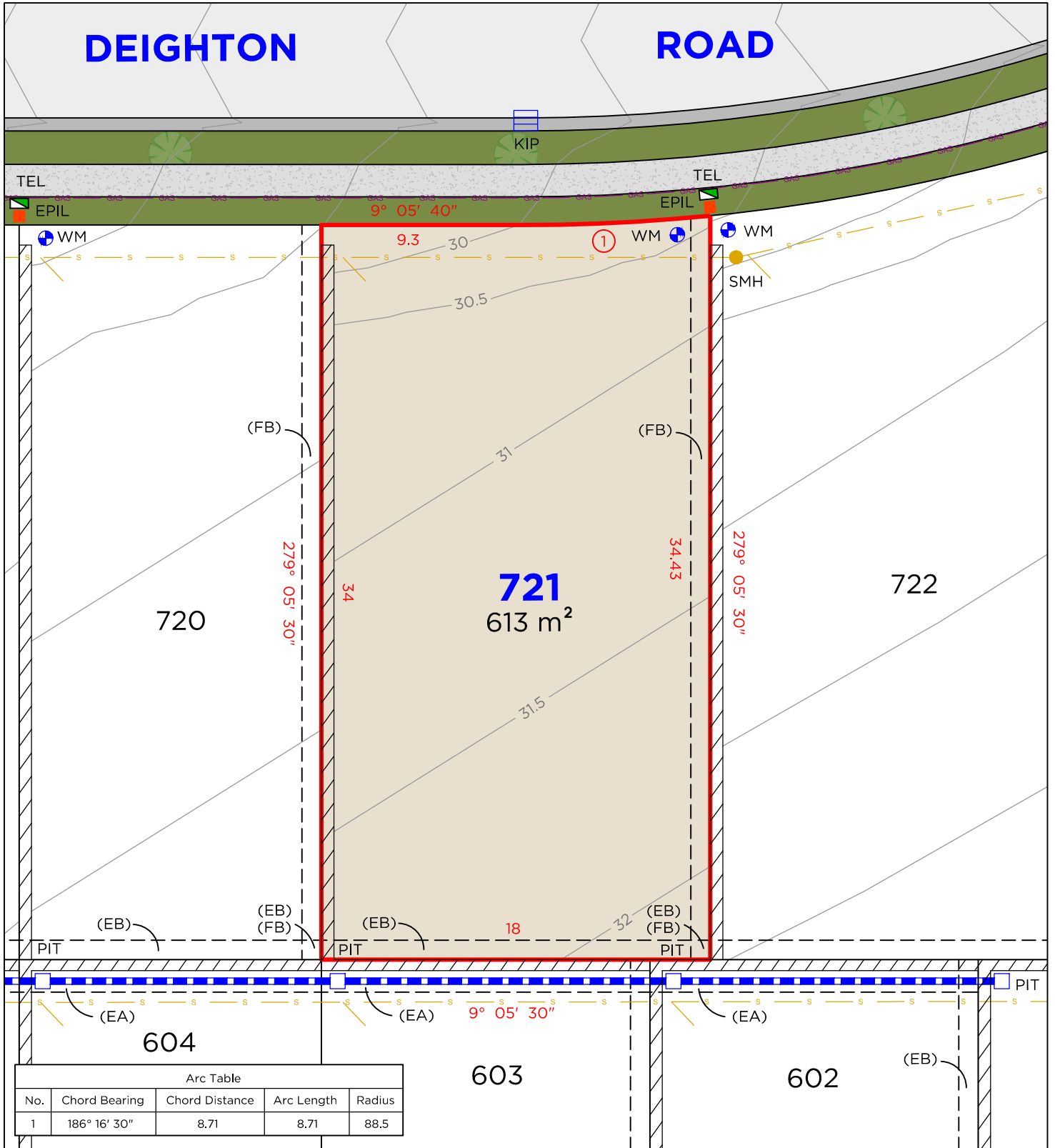

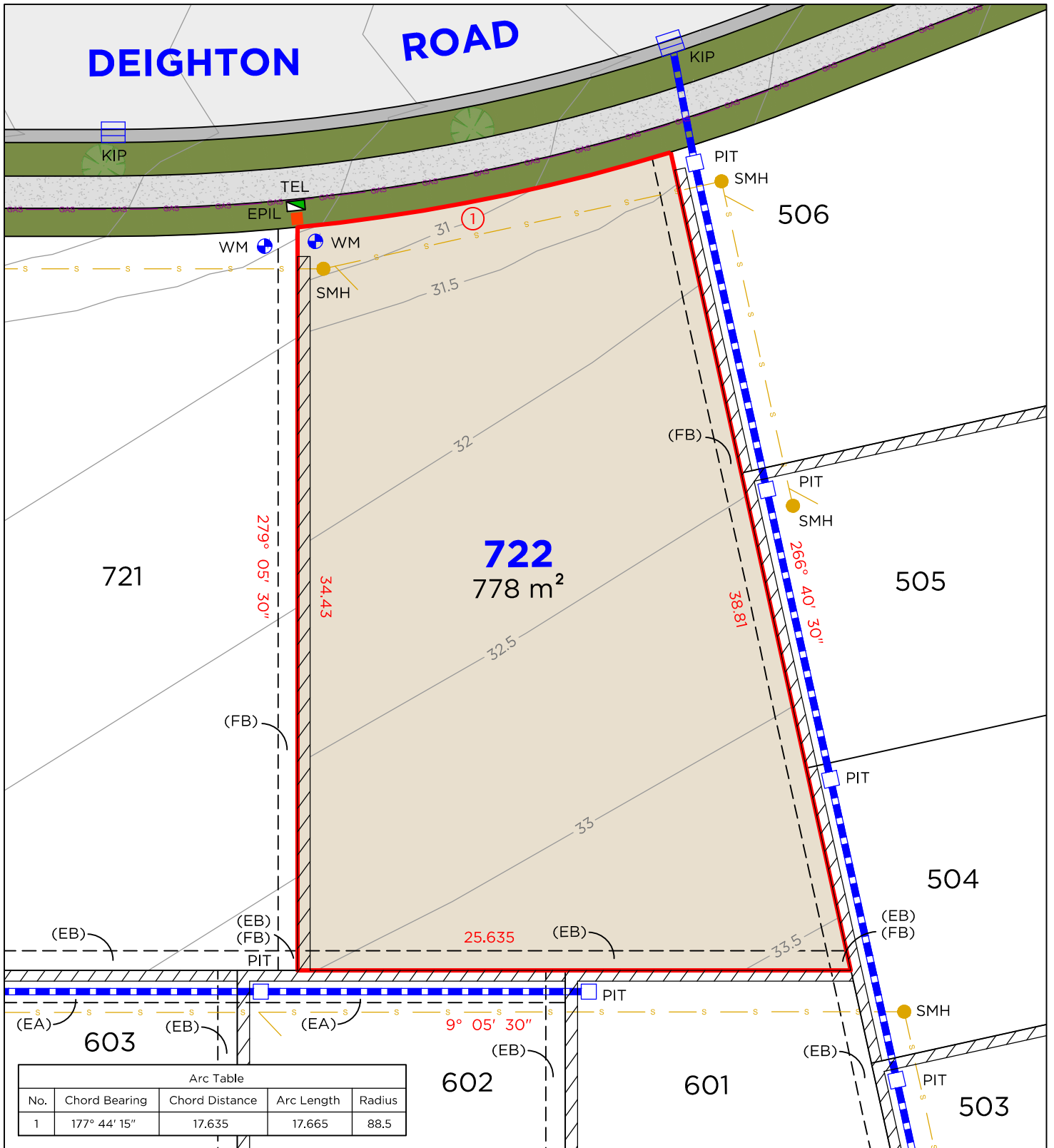

**DELFS LASCELLES**  
CONSULTING SURVEYORS

**The Loxford**

**EASEMENTS**

(EA) EASEMENT TO DRAIN WATER 1.5 WIDE  
(EB) EASEMENT FOR SUPPORT OF RETAINING WALL 0.9 WIDE  
(FB) EASEMENT FOR SUPPORT OF RETAINING WALL 0.9 WIDE

**DISCLAIMER**

- THIS PLAN HAS BEEN COMPILED FROM DESIGN PLANS AT THE SCALE/S STATED. IT IS RECOMMENDED THAT A SURVEY IS UNDERTAKEN PRIOR TO THE PREPARATION OF CONSTRUCTION DRAWINGS. THE PLAN IS SUITABLE FOR DESIGN ONLY & MAY NOT BE SUITABLE FOR ANY OTHER PURPOSE OR FOR USE AT ANY OTHER SCALES/S.
- THE BOUNDARIES & SERVICES SHOWN ARE APPROXIMATE ONLY. FURTHER SURVEY WILL BE REQUIRED IF CONSTRUCTION IS TO TAKE PLACE ON OR ADJACENT TO THE BOUNDARIES.